

# BOX

## IMF24-2RGBW50-10a30RH

### Application

This family of spotlights is crafted for dynamic flood and accent lighting of facades, seamlessly incorporating all of INTILED's cutting-edge technical innovations into a meticulously balanced and compact design.



Light color	red + green + blue + white 5000 K	
CRI	> 80	
Color binning	±3 nm, 2 MacAdam steps	
Optics, degrees	10a30	
Delivered lumens, lm	Red	700
	Green	1 050
	Blue	410
	White 5000 K	1 350
	All On	1 750
Voltage, V	230 AC 50 Hz	
Wattage, W	50	
Power factor	> 0,9	
Electric class	I (first)	
Protection class	IP66	
Operating temperature, degrees C	-40 ... +55	
IK rating	IK09	
Control, protocols	DMX-512 + RDM	
Control, pixel size	1 luminaire = 1 pixel	
Lifespan, hours	Not less than 50 000	
Warranty, years	5	
Dimensions, mm	206x206x110	
Weight, kg	3,5	
Content of delivery	luminaire, package, passport, mounting instructions	

Standard RAL colors

1015	1001	8004	8017
9005	7016	9006	9003

Standard coating type  
moire

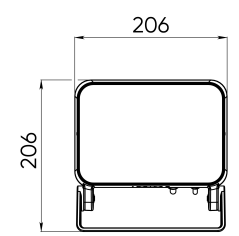
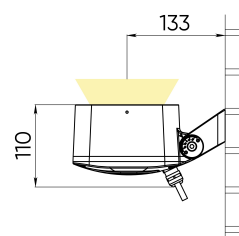

### Mounting

Surface mounted, on a swivel bracket.

### Materials

Housing, bracket — cast aluminum; protective glass — tempered glass.

### Integrated technologies

ColorPro® technology is a software algorithm that optimizes the use of the luminaire's available power to deliver peak brightness.

EternalTechnology® is a continuous monitoring of the internal temperature of the lighting fixture through the system of integrated sensors.

Truelight® technology - a comprehensive suite of solutions designed to deliver flawless lighting effects.

Aquatech® technology – a multi-stage protection technology safeguards luminaires against water ingress.

COOLight® technology is aimed at increasing the efficiency of lighting fixtures.

## **Additional codes definition**

### **Accessories**

#### brackets

BOX-01-100 - for the pole, swivel (1 hole)

BOX-02-100 - for the pole, swivel (2 holes)

BOX-03-75 - for the pole, static

#### grids

BOX-01-030 - 20 cells, 30 mm height

BOX-02-050 - 6 cells, 50 mm height

#### tubes

BOX-01-090 - 90 mm height

BOX-01-140 - 140 mm height

#### louvres

BOX-02-050 - 50 mm height

BOX-02-070 - 70 mm height

BOX-02-100 - 100 mm height

### **Compatible control system devices**

LightCAD software key x2

LightCAD software key x8

LightCAD software key x32

LightCAD software key x64

LightCAD software key x128

LightCAD software key x512

Controller LED-IPCe

Controller LED-IPCs

Converter U-Box 8

Converter U-Box 4

Converter Din-Box 8

Converter Din-Box 6

Converter Din-Box 2

Splitter DMX (B1T2)

Splitter DMX (B4)

Converter UCS-ILCS