

IntiPOINT

A spotlight used for decorative lighting and media façades. Each luminaire is individually controlled using the standard DMX-512 protocol.

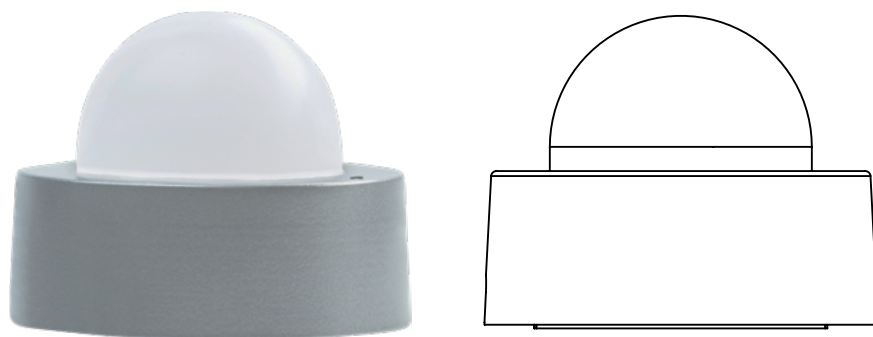

Application

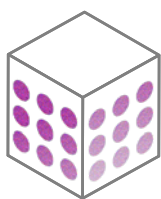

media façade

IntiPOINT



180°

CRI

≥80 (for white color)

Color Binning

2 MacAdam ellipses for white,
±3 nm for color LED

Voltage

24 V DC

IP67



Lifespan

not less than 50 000 hours

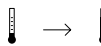
- 40°C + 55°C

Controls, protocols

DMX-512 – additional hardware required

Controls, pixel size

1 luminaire – 1 pixel

Materials

housing – cast UV-resistant polycarbonate

protective glass – frosted spherical diffuser

mounting plate – stainless steel

Standard RAL colors



9006

Standard coating type

moire

Customization

cable outlet: side/bottom

light color, wattage and luminous flux customized
for a specific project

Available custom versions

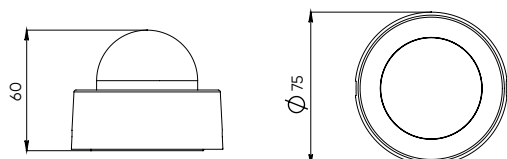

weight, kg
0,2

IntiPOINT

monochrome

1. Select a modele

Serial code	Color	W, max	lm, max
IRF3-1	white color mono	3,7 5	100 90

2. Create an article number

Serial code	Color	Optics	Controls*	Supply voltage **
IRF3-1	W30 W40 W50 G B	180	C	L24

* C – protocol DMX-512, additional hardware required

**L24 – supply voltage 24 V DC

multichannel

1. Select a model

Serial code	Color	W, max	lm, max
IRF3-1	RGB	3,3	43

2. Create an article number

Serial code	Color	Optics	Controls*	Supply voltage **
IRF3-1	RGB	180	C	L24

* C – protocol DMX-512, additional hardware required

**L24 – supply voltage 24 V DC